



Product Features

- User friendly design catered for everyday usage
- Solid brass body with high quality chrome finishing
- Impervious body structure capable of withstanding high volumes of use
- Child and elderly friendly

Product Specifications

Material : Brass with Chrome Finish

Dimensions

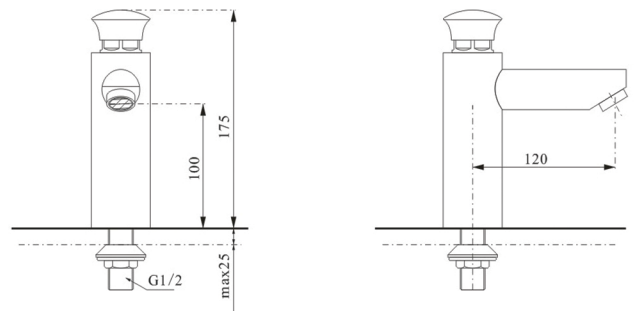

Testing Report

Test Report No. 7191057860-MEC13/01-CLC
dated 16 APRIL 2013



TEST RESULTS:

Hydraulic Characteristics

2) Description: Delay Action Basin Tap
Model: D-15K

| Flow Pressure (bar) | Flow Rate (litres/min) | Flow Rate Requirements for Water Efficiency Labelling | Photo |
|-----------------------|--------------------------|---|-------|
| 0 | 0 | | |
| 0.5 | 0.8 | | |
| 1.0 | 1.2 | | |
| 1.5 | 1.6 | | |
| 2.0 | 1.6 | | |
| 2.5 | 1.6 | | |
| 3.0 | 1.7 | | |
| 3.5 | 1.7 | | |
| 4.0 | 1.8 | | |
| 4.5 | 1.9 | | |
| 5.0 | 1.9 | | |
| 5.5 | 2.0 | | |

Products/Fittings
Basin Taps & Mixers

4 to 6 litres/min (1 tick)
2 to 4 Litres/min (2 ticks)
2 litres/min or less (3 ticks)

Water Efficiency

WELS Rating : Excellent ✓✓✓

Water Flow Rate : 1.70 Litres/ Minute

Resistration No. : BST-2013/ 012815

Water Efficiency Mark

